

proxSafe®

Key Management & Smart Storage Systems

The intelligent management system for keys and equipment with comprehensive audit and reporting capabilities. Control who can have access to individual items and restrict when they can be taken. Keys, radios, test equipment, tools, laptops and much more can now be managed efficiently with increased accountability so you know where they are and who has them. The powerful software Commander Connect allows easy configuration and control of access rights, time profiles and the creation of individual reports. That way you stay in control at all times and make the best use of your equipment.

Terminal Base Station

Generally speaking, standard terminals consist of a monitor or display and an input unit. In a proxSafe environment the input unit consists of a keyboard and an RFID reader. The TBS has been developed to ensure terminal basis functions are kept strictly separate from the operating controls of the system.

The TBS contains a keyboard, an RFID reader, required for user ID and keyTag return, as well as a CPU capable of managing up to 100 000 keyTags.

If required, it is possible to connect a camera for the user image as well as a documentation camera to the CPU.

The input unit can either consist of a PC with touch terminal or a touch PC; the unit is connected to the TBS via an Ethernet port. This resolute separation makes it extremely easy to realise customer preferences, because the user interface is easily reconfigured.

As part of the basis functions the TBS includes an optimum energy management system with a very efficient emergency power function.

Your benefits at a glance:

- **Keyboard for user identification**
- **Energy management for emergency power function**
- **Multi technology reader for user identification**
- **Fast key return via 125 kHz reader**
- **Network and standalone capability**
- **Documentation and user cameras optional**

maxx TTM, bloxx, locker L

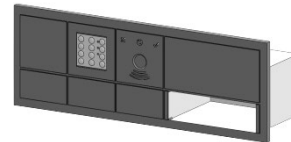

TBS-LC

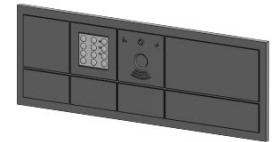

TBS-L

locker S

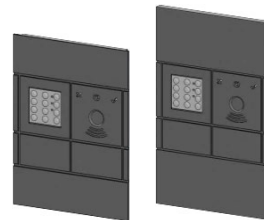

TBS-S12

TBS-S14

External, locker M

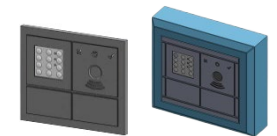

TBS-E

TBS-H

Technical data

Dimensions W x H x D /

TBS-E:	196 x 162 x 65 mm
TBS-H:	260 x 228 x 70 mm
TBS-L:	457 x 158 x 65 mm
TBS-LC:	457 x 158 x 150 mm
TBS-S12:	195 x 259 x 65 mm
TBS-S14:	195 x 312 x 65 mm

Material: Plexiglas, POM

Operating temperature: +5...+50°C

Relative humidity: 5...95%, non-condensing

Operating system: Linux

Interface: Ethernet

Power requirement: 12 V

Keypad: Yes

Energy management: Yes, with emergency power function

Optional: Camera for user
Documentation camera